



**THE
JUNE CANAVAN
FOUNDATION**

January 2025 Newsletter

Hello everyone,

Happy New Year and welcome to the January 2025 edition of the June Canavan Foundation newsletter. This edition will cover the following topics:

- Opening of *L'Orient* on the site of June's surgery
- Thanks to Queensland Alpine Sports Medicine
- Who we've funded
- A Curious Tractor – introducing our new partner
- Our refreshed website
- Refining our Impact – new goals and targets

INVITATION

You are invited to this year's

Trip to Tanzania

10 - 17 September 2025

We will visit our partners in Tanzania including:

The School of St Jude

Tanwaste

Maasai Women's Social Enterprise

Options for treks up Mt Kilimanjaro and/or Mt Meru and safari trips to the Serengeti will also be organized depending on interest.

For more information talk to Anne at anne.gripper@outlook.com or 0409 813 260

L'ORIENT: UNVEILING OF JUNE'S TREE and PLAQUE

As those of you on the Sunshine Coast will have noticed, the site of June's medical clinic and "Jalloonda", the old Queenslander on the Maroochy River behind her clinic now has a very different look. The new apartment building, called "L'Orient" has been completed and officially opened.

As part of the sale to local development company, Mosaic, their CEO, Brook Monahan made a generous donation to the Foundation and agreed to keep us in the loop about plans for the site.

The proceeds of the sale of June's Duporth Avenue properties are currently providing the funds for the final 7 years of the Foundation's giving. In appreciation of June's service to the Sunshine Coast, Brook said "I suspect it will be one of the buildings we are most proud of for a very long time. We will obviously do everything we can do to do justice to the special site the building sits upon".

In March, we were delighted to be invited to attend an opening ceremony including the unveiling of a plaque at the base of the feature tree at the entrance to *L'Orient* which was planted in honour of June's service to the Sunshine Coast community.

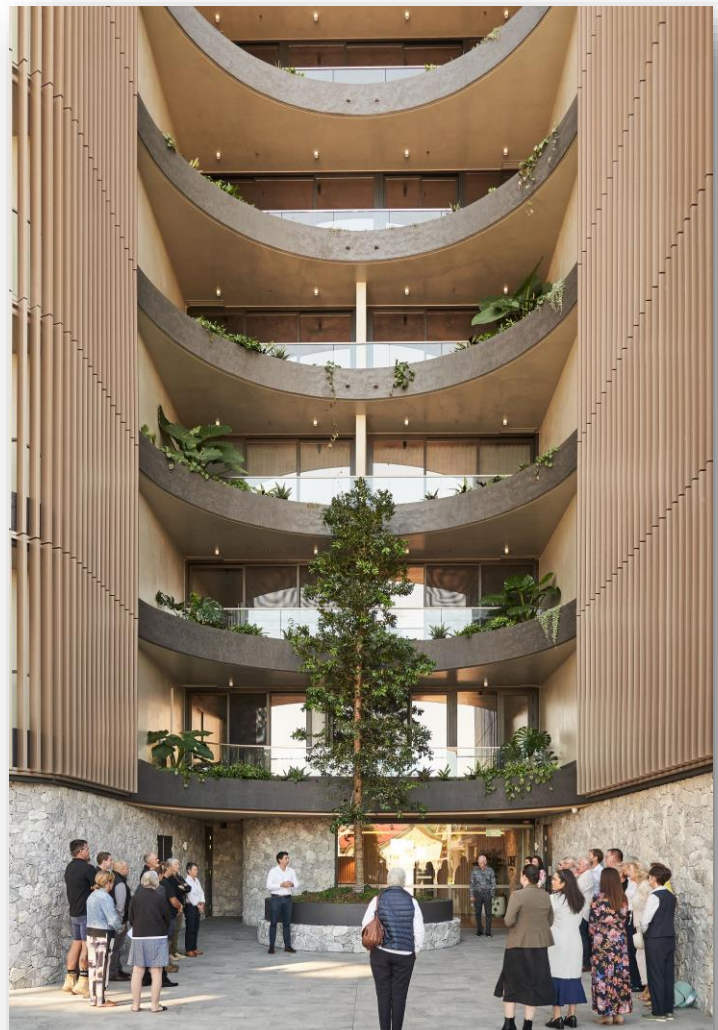

The tree at the front entrance of L'Orient



It was great for six of our JCF Board members to mingle with new owners over morning tea. Bruce and David from Mosaic talked about their commitment to honouring June's history on the site and Anne shared stories of June's, sometimes quirky, but always compassionate medical practice. It was a chance to swap happy stories of times old and new on the site. Special mentions to our furthest travellers - June's sister and brother-in-law Lorraine and David Griffiths who made the longest trip from Greta West near Wangaratta.

And a nice circle of history – Robyn Kennaugh who was a physiotherapist in June’s clinic for many years, is now an owner of one of the apartments in *L’Orient*.

Knowing June would not be at all happy with just an everyday normal apartment building, we were happy to be part of the opening of a refined and distinctive building which absolutely suits its location.



Local MP, Fiona Simpson, David Handley from Mosaic, JCF Board members – Maureen, Kerry, Merran, Anne, Lorraine, Jo and Bruce Wortley from Mosaic

THANKS TO JUNE’S SKIING COLLEAGUES

A big thanks to our longstanding supporters and donors – the **Queensland Alpine Sports Medicine Association**. June was an active member of the QASM. Each winter, she enthusiastically joined the group for their conference and ski trip to Smiggins Holes. The group contribute to June’s legacy living on as a catalyst for change by organising the June Canavan Ovation at the ski conference each year.

This year the QASM made an extra special donation of \$5000 which they requested be divided across five of our recent beneficiaries. This generous donation was initiated and coordinated by June’s trusted friend and colleague, Dr Peter Myers. QASM requested that their donation be considered as part of our Matched Fundraising process ([Matched Fundraising Program - June Canavan Foundation](#)) so that each of their nominated organisations received a matched donation of \$1000 from the JCF. The five lucky organisations receiving their bonus \$2000 donations were:

- Sports Excellence Scholarship Fund
- Women Onside
- Confident Girls Foundation
- Sunshine Butterflies
- Cycling without Age Wangaratta
-



WHO WE HAVE FUNDED

During the 2023/2024 year we provided funding to some wonderful organisations who are doing great things for the community. We choose them from a broad range of applications based on their alignment with our JCF values and Impact Framework. Before allocating any funding we always ask ourselves the question “Would June like this project?”.

If you’d like to see all the projects and organisations we have funded since 2021 they are available on our website at the following link: [Recipients - June Canavan Foundation](#)

Organisation	Project	JCF Focus / Geographical area	Amount
Alpine Valleys Community Leadership Program	June Canavan Scholarship	Education North East Victoria	\$10,000
Alpine Valleys Community Leadership Program	Capacity Building	Education North East Victoria	\$20,000
Confident Girls Foundation	Matched funding with QASM	Sport North East Victoria	\$2,000
Cycling Without Age	Matched funding with QASM	Health North East Victoria	\$2000
Friends of Lacluta	Vocational Scholarships	Education Wangaratta and East Timor	\$2,500
Greta Valley Landcare Group	Biodiversity Stepping Stones	Conservation North East Victoria	\$6000
The Pyjama Foundation	Love of Learning Program	Health / Education Sunshine Coast	\$10,000
Project Vietnam	Microfinance for farming families	Microfinance Sunshine Coast / Vietnam	\$5,000
Savage Films	Production of <i>Unbreakable: Jelena Dokic's story</i>	Sport National	\$20,000
Sunshine Butterflies	Triathlon for all abilities + Matched funding with QASM	Sport Sunshine Coast	\$8,000 + \$2,000
The School of St Jude	Scholarships for Girls in Secondary School	Education Tanzania	\$35,000
Sports Excellence Scholarship Fund	Scholarships for Rural athletes + Matched Funding from QASM	Sport North East Victoria	\$5,000 + \$2,000
Start Some Good	Women’s social enterprise scholarships	Education / Growing Giving National	\$20,000
Tomorrow Today Foundation	Evaluation of Education Benalla Program + Participate! Sports Program	Education / Sport North East Victoria	\$20,000 + \$15,000
University of the Sunshine Coast	Para Sport and Regional Scholarships	Education Sunshine Coast	\$31,000 + \$31,000

Organisation	Project	JCF Focus / Geographical area	Amount
Wantaim PNG	Capacity Building	Education Papua New Guinea	\$22,500
WomenCan Australasia	Women's Driving to Employment Program, Wodonga	Education North East Victoria	\$20,000
Women Onside	Women's Football Leaders Conference + Matched Funding with QASM	Sport National	\$15,000 + \$2,000

INTRODUCING A CURIOUS TRACTOR – OUR NEWEST PARTNER

We are delighted to be supporting a start-up organisation called “A Curious Tractor”.

In early 2023, a phone call from a guy called Nic who wanted to have a chat about a possible connection with the JCF signalled the start of a slow but steady move into a formal partnership. Nic had recently purchased a parcel of land in the Sunshine Coast Hinterland at Witta.



Nic talking to the JCF Board at the indoor/outdoor meeting room at June's Patch



He had also fulfilled a childhood dream of owning a tractor. With his land and a tractor he was all set to do good things through a new social enterprise called “A Curious Tractor”.

Nic has a good track record of growing small things into big things. Turns out he was not just any old Nic. He was actually Nic Marchesi OAM. Back in 2014 as aspirational 20-year-olds, he and his mate Lukas Patchett had thrown a couple of washing machines on the back of a ute to offer free laundry and conversations for people

doing it tough. 10 years later, the now mighty Orange Sky Laundry (www.orangesky.org.au) is one of Australia's highest impact charities.

Nic is now in the exploratory stages of creating a different sort of impact. Many of his thoughts are aligned with what we think June would have liked to see happen in her neighbourhood, including the setting aside a part of the land to be named *June's Patch*. Amongst other things, *June's Patch* will be used for:

- Growing nutrient dense foods which will be provided to disadvantaged communities rather than their usual path to high class restaurants
- Offering a residential bush environment for respite and healing for overworked health professionals
- Offering a place of connection for medical researchers and medical practitioners
- Offering a place of learning about horticulture and hospitality for young people entangled in the youth justice system.



Hard at work during our Board meeting with Lorraine beaming in via Zoom

The JCF Board were delighted to accept Nic's suggestion that we hold our October 2024 Board meeting on *June's Patch*. On Saturday, we conducted our meeting in the very finest indoor / outdoor meeting room. We then enjoyed pizzas coming out of the woodfired pizza oven before retiring to a variety of cabins and tents on Saturday night. On Sunday morning we enjoyed a challenging walk through the rainforest to the creek that runs through the property.

It's early days yet for Nic and his enterprise partner Ben Knight, but we are excited to be with them from the beginning. Having made a \$30,000 donation earlier this year, it was an easy decision for us to decide on a second grant of \$30,000 for them to use next year.

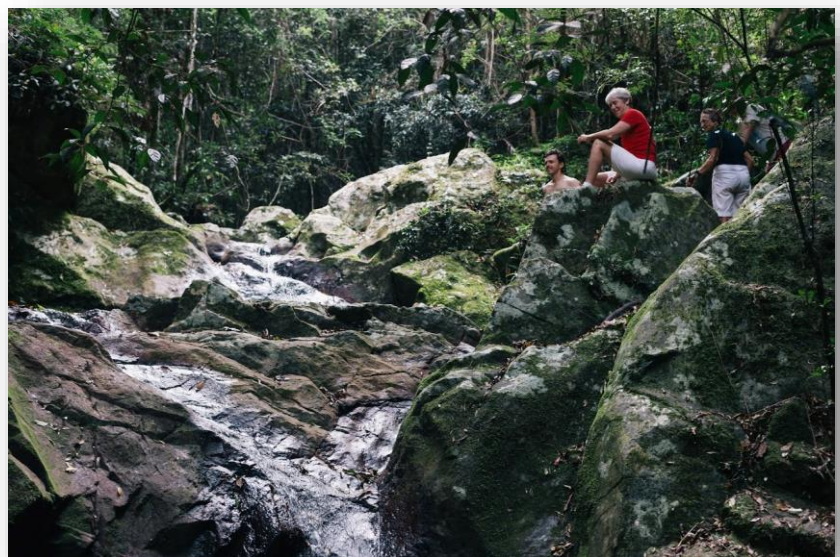

A steep walk through the rainforest down to the creek on Sunday morning was an extra treat

OUR REFRESHED WEBSITE

We urge you to have a look at our refreshed website [June Canavan Foundation](#).

Back in 2015, Excite Media in Brisbane guided us through the process of establishing a contemporary website which has served us well. We were happy to re-engage with Excite Media for a “refresh” of the site which should now see us through the final 7 years of the life of the JCF.

The refreshed site has a brighter, cleaner look which is easier to navigate. It integrates our Impact Framework properly and makes it clearer for funding applicants to determine whether they are aligned with our focus areas, values and criteria.

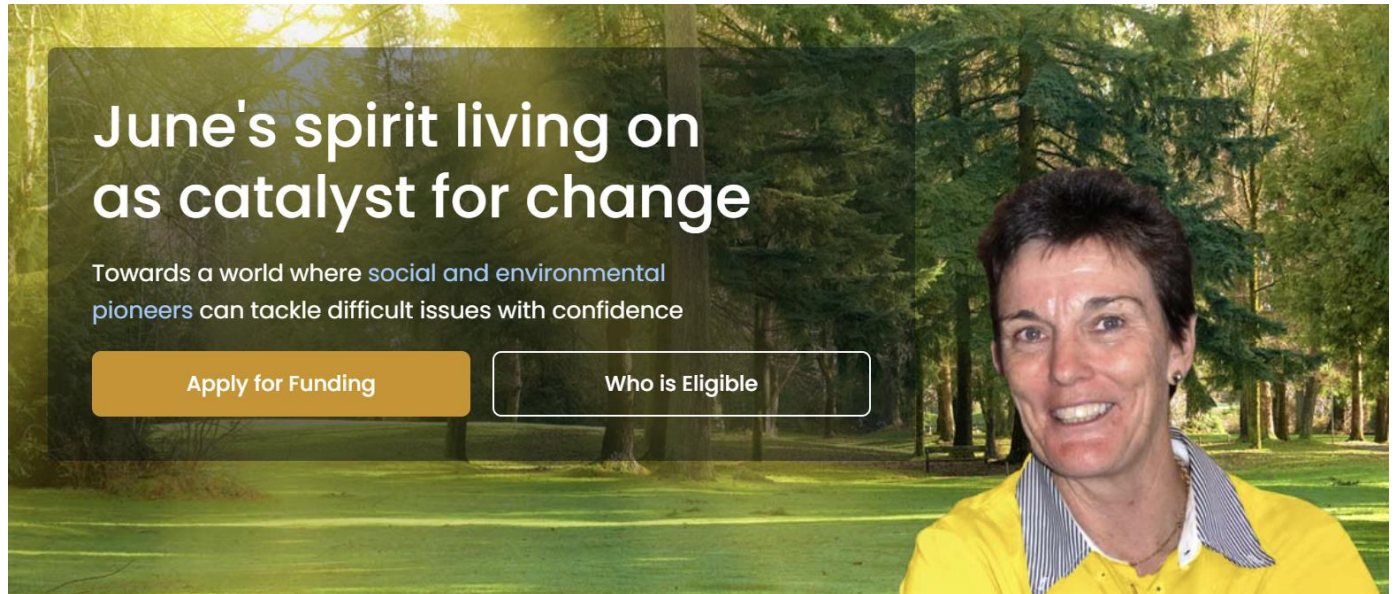

REFINING OUR GOALS AND TARGETS

For the last couple of years, JCF Board members have been interested in refining our focus areas and using the United Nations Sustainable Development Goals, commonly known as the SDGs, to guide a more focussed approach to our grant making. Since we began in 2011, we have been conscious that our grant making has been very broad ranging, and we wondered whether better defining our goals and targets would help us have more impact. In March this year, our Company Secretary, Jo Saies facilitated a workshop in which we considered all of these issues.

As a result, we now have a document which clearly sets out the specific areas of Sport, Education, Health and Conservation that we are interested in funding. Our work contributes to five SDGs:

SDG 3. Good Health and Well-Being

SDG 4. Quality Education

SDG 5. Gender Equality

SDG 14: Life Below Water

SDG 15: Life on Land

SUSTAINABLE DEVELOPMENT GOALS



You can see the full document which emerged from our workshop at Appendix A at the end of this newsletter.

CONGRATULATIONS TO EMILY BEECROFT

For the last 8 years we have provided two different types of June Canavan scholarships for students at the University of the Sunshine Coast (USC):

- Regional Scholarships for female students from the country
- Para-Sport Scholarships for students training for the Paralympics

Several of our Para-Sport scholarship holders over the years have gone on to represent Australia in World Championships and the Paralympic Games.

Last year, we were proud to support Emily Beecroft who won Gold and Bronze medals at the 2024 Paris Paralympics. Her gold medal was in the Mixed 4×100 m freestyle relay and she won her Bronze in the S9 Women's 100 m butterfly. She also finished fourth in the S9 Women's 100 m freestyle S9.

Emily balanced her swimming training while studying for a Bachelor of Communications degree at USC. Congratulations Emily!



HOW YOU CAN HELP

We're always on the lookout for projects and organisations that June would have liked us to support. We are keen to support social enterprises who need "a hand up" to get themselves up and running, rather than a "hand out". If you know and like a particular social enterprise or charity please contact us to discuss funding options.

If you are keen to raise money for the June Canavan Foundation you can do this through our matched fundraising process. You select any organization we have supported over the last 3 years and we will match any funds you raise up to \$5000.

That's it for this edition. If you are interested in hearing more about our trip to Tanzania or if you have any suggestions or comments about the Foundation please let me know on [0409 813 260](tel:0409813260) or at anne.gripper@outlook.com

Bye for now,

A handwritten signature in black ink that reads "Anne Gripper". The signature is written in a cursive, flowing style.

Anne Gripper

JCF Cause Area	Goals of each Focus area	The targets we are contributing to
SPORT	Increasing women's participation and leadership in sport	SDG 5 Gender equality Target 5.5 Ensure women's full and effective participation and equal opportunities for leadership at all levels of decision-making in political, economic and public life
	Creating psychologically safe environments for elite athletes	JCF Target By 2030 ensure athletes do not suffer adverse mental health outcomes caused by their participation in, or transition from, elite sport
EDUCATION	Increasing access to primary and secondary education	SDG 4 Quality Education Target 4.1 By 2030, ensure that all girls and boys complete free, equitable and quality primary and secondary education leading to relevant and effective learning outcomes
	Increasing access to vocational, technical and entrepreneurial skills	SDG 4 Quality Education Target 4.4 By 2030, substantially increase the number of youth and adults who have relevant skills, including technical and vocational skills, for employment, decent jobs and entrepreneurship
HEALTH	Improving maternal health	SDG 3 Good Health and Wellbeing Target 3.1 By 2030, reduce the global maternal mortality ratio to less than 70 per 100,000 live births
	Improving palliative care	Palliative Care Australia Goal 3 Access and Choice JCF Target: By 2030 ensure all Australians in palliative care can die in a place of their choice, with minimal discomfort
CONSERVATION	Protecting habitats for animals	SDG 15 Life on land Target 15.5 Take urgent and significant action to reduce the degradation of natural habitats, halt the loss of biodiversity and, by 2020, protect and prevent the extinction of threatened species
	Protecting habitats for marine life	SDG 14 Life Below Water Target 14.4 By 2020 sustainably manage and protect marine and coastal ecosystems to avoid significant adverse impacts
GROWING GIVING	Building capacity in the philanthropic sector	Philanthropy Australia Target 1 Ensure that philanthropy's role in Australian is strengthened
	Encouraging people to commence or expand their planned giving	Philanthropy Australia Target 2 By 2030 double structured giving from \$2.5 billion in 2020 to \$5 billion